

1 pz.

Alluminio
Spessore 10 mm

Scatola per EOM
Tav. 1: Base
scala 1:2

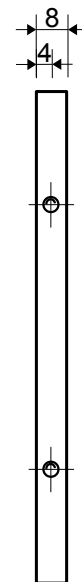
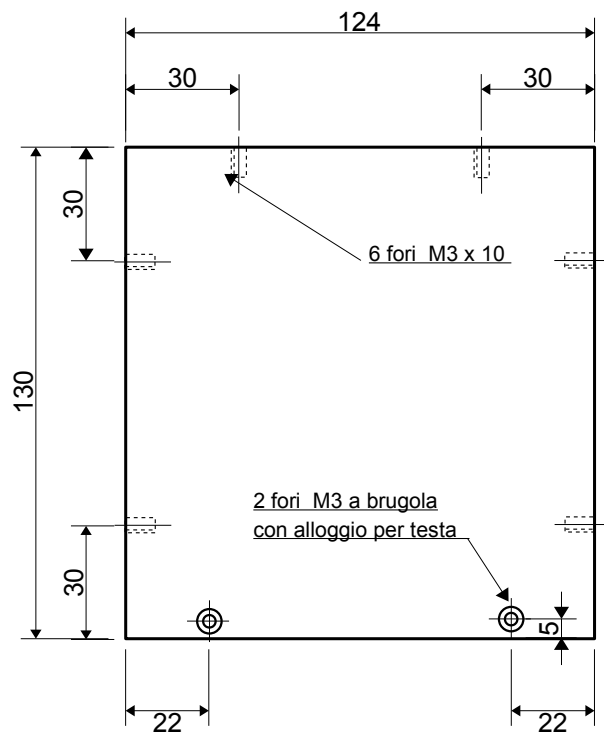

1 pz.

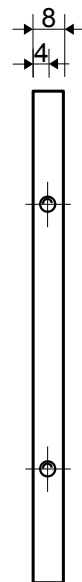
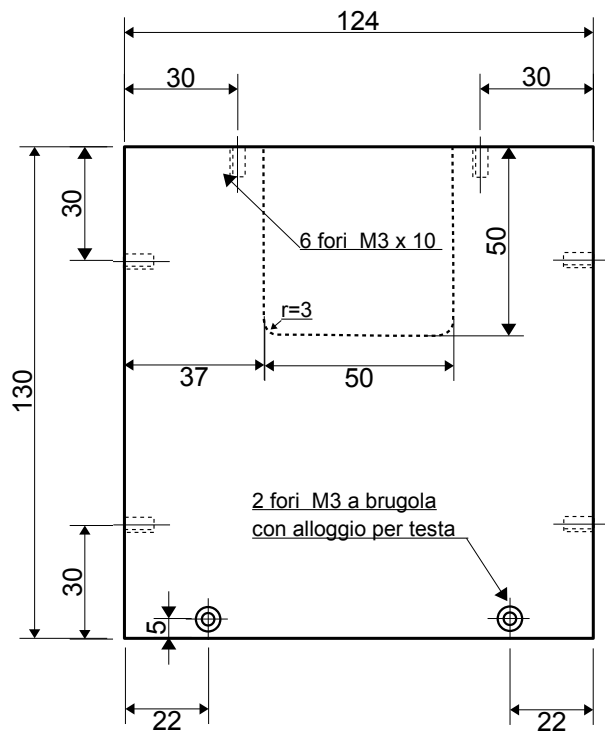
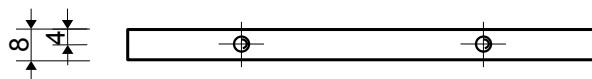

1 pz.

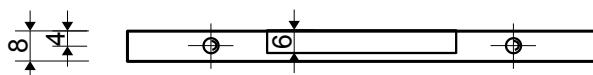

Scatola per EOM
Tav. 2: Laterali
scala 1:2

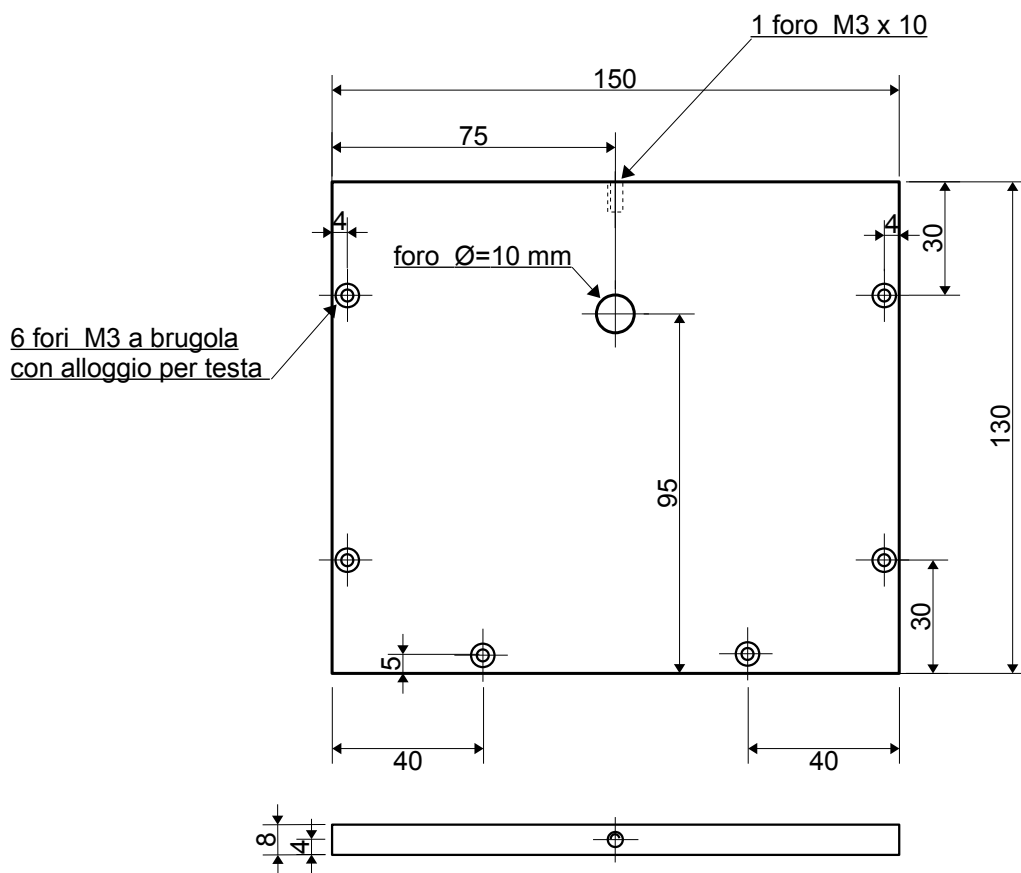

2 pz.

Scatola per EOM
Tav. 3 Frontali
scala 1:2

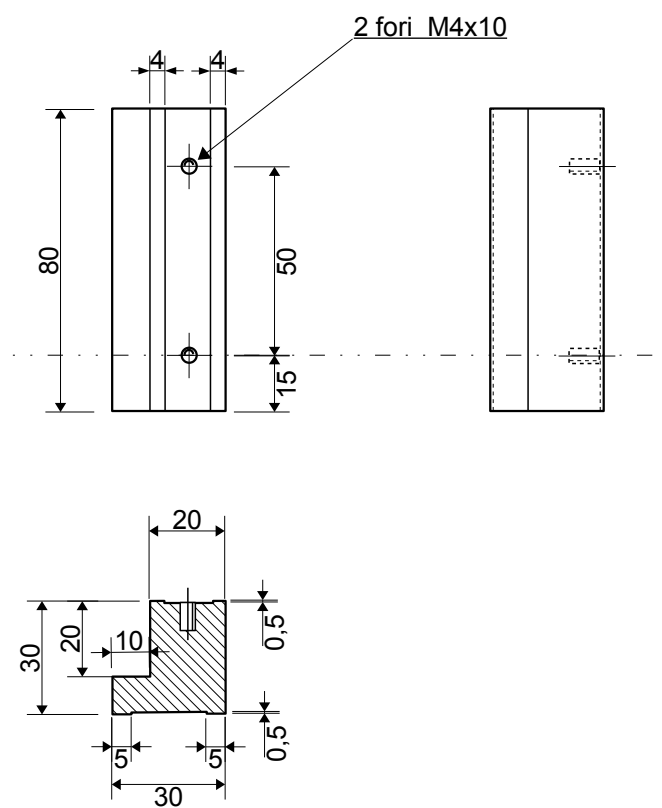

2 pz. Plexiglass o materiale isolante rigido

Scatola per EOM
Tav. 5: piede
scala 1:2

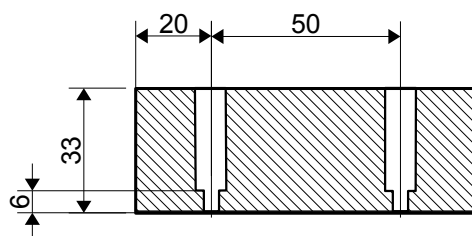
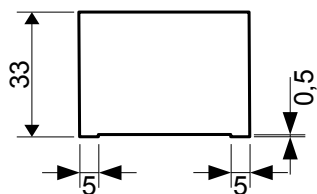

Sez. AA'

1 pz.

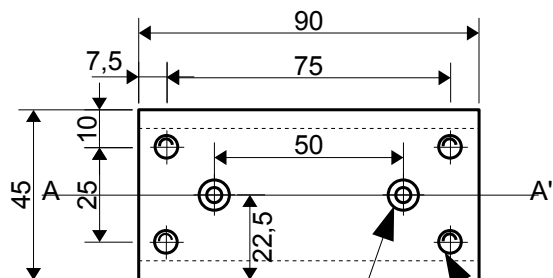

2 fori vite M4 a brugola
con alloggiamento per testa

4 fori M6 x 10

Scatola per EOM
Tav. 7: sostegno
scala 1:2

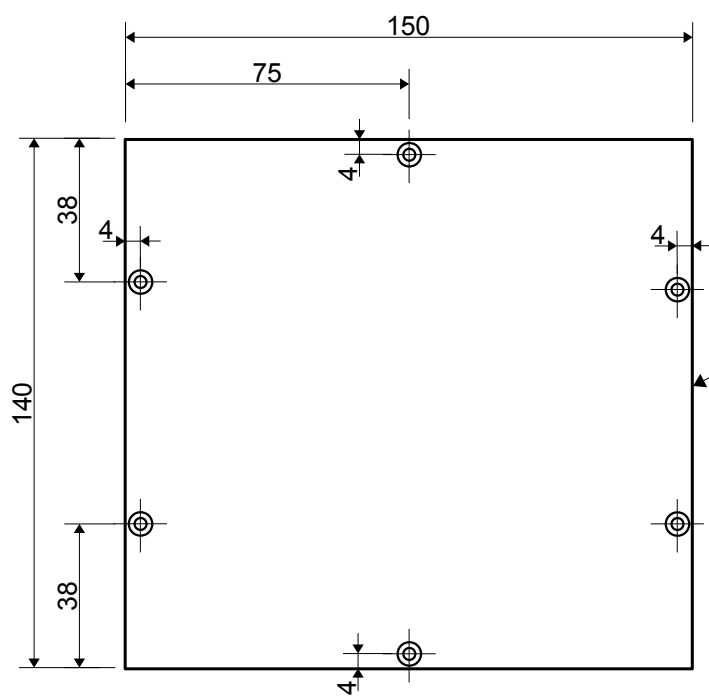

1 pz.

6 fori M3 a brugola
con alloggiamento per testa

Alluminio
Spessore 8 mm

Scatola per EOM
Tav. 4: coperchio
scala 1:2